

house.

PARTNERSHIP

Moving estate agency on



h.

FLAT 2 BEECHOLME

23 Warwicks Bench
Guildford GU1 3TF

With spectacular views across Chantry Wood and south Guildford, a spacious, light and airy apartment being offered in immaculate condition, fully furnished and with private garden

- Communal entrance
- Entrance hall
- Sitting room / kitchen and utility cupboard
- 3 bedrooms
- Family bathroom
- Cloakroom
- Balcony
- Private garden with shed
- Allocated parking space
- EPC: D



h.



h.



properties perfectly presented



h.

Approximate Gross Internal Area = 96.8 sq m / 1042 sq ft
Outbuilding = 7.3 sq m / 78 sq ft
Total = 104.1 sq m / 1120 sq ft

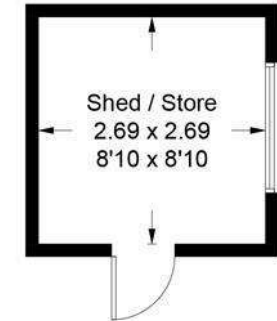
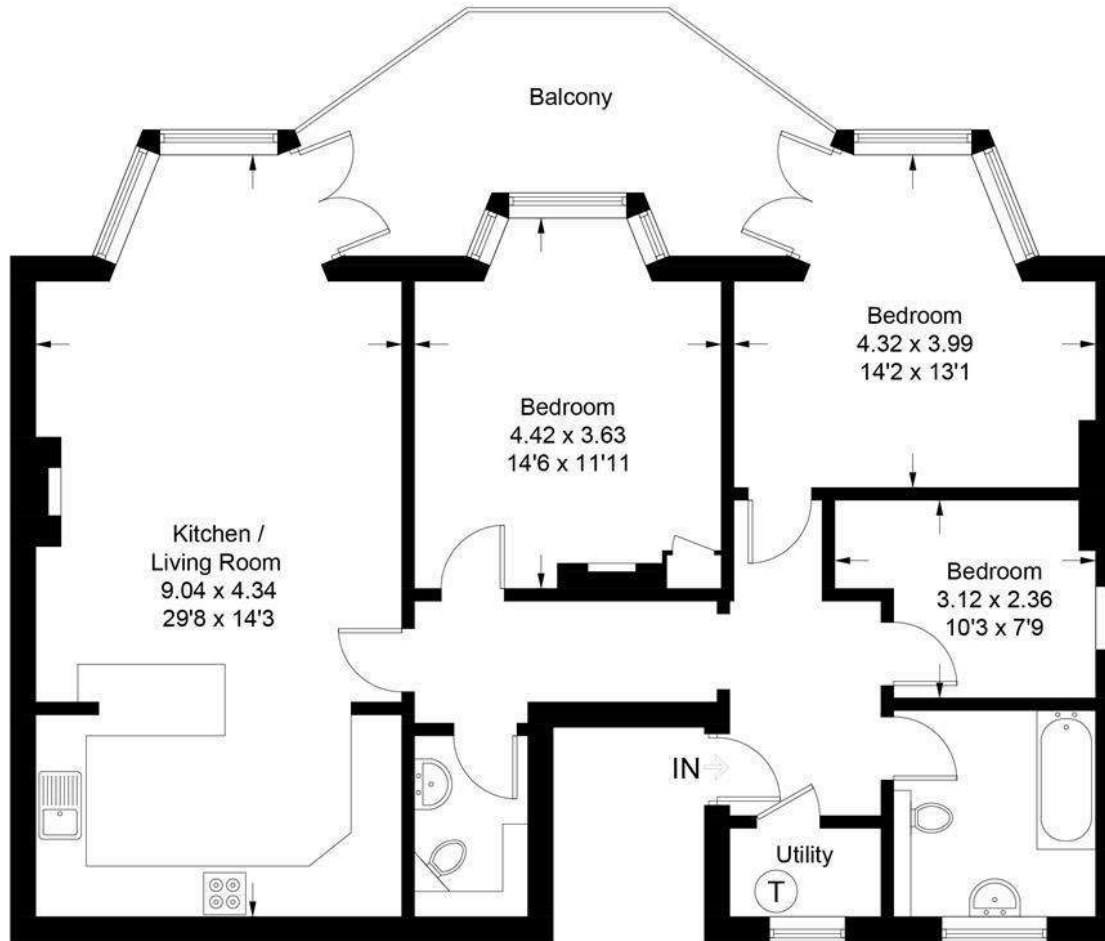

(Not Shown In Actual Location / Orientation)

First Floor

This plan is for layout guidance only. Not drawn to scale unless stated. Windows and door openings are approximate. Whilst every care is taken in the preparation of this plan, please check all dimensions, shapes and compass bearings before making decisions reliant upon them. (ID692986)

www.bagshawandhardy.com © 2020

h.

HOUSE INFORMATION

Total gross internal area: Apartment 1,042 sq ft / 96.8 sq m; Shed 78 sq ft / 7.3 sq m; Total 1,120 sq ft / 104.1 sq m.

Services: All mains services. Gas-fired central heating.

Local authority: Guildford Borough Council.
Tel: 01483 505050.

Viewing: Strictly by appointment. Tel: 01483 266721.

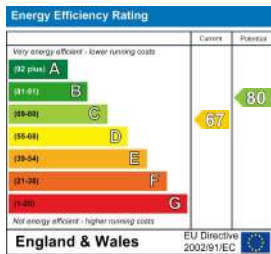

t. 0800 917 0447

w. housepartnership.co.uk

f in p @